

# The Combustex Series 100

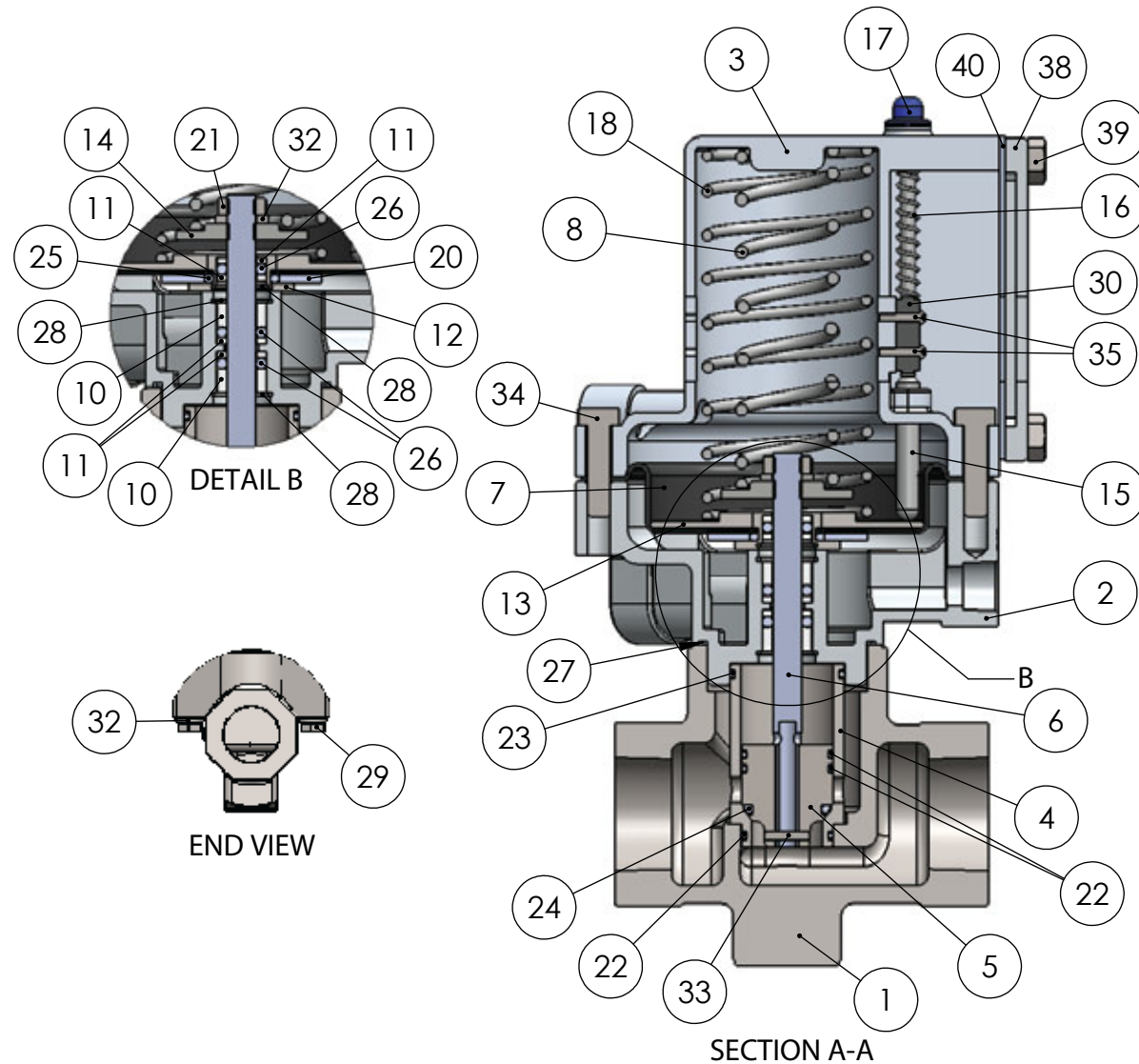

C/I Proof of Closure Safety Shutoff Valve



Item	Qty.	Description	Part No.
1	1	Valve Body	100-001-1
2	1	Bonnet	100-002-1
3	1	Spring Case (P.O.C. Model)	100-003-2
4	1	Cage	100-005-1
5	1	Valve Plug	100-006-1
6	1	Valve Stem	100-013-2
7	1	Diaphragm	100-014-1
8	1	Inner Valve Spring - 3-15 PSI (P.O.C. Model)	100-016-1
9	1	Inner Valve Spring - 6-30 PSI (P.O.C. Model)	100-016-2
10	2	Stem Seal Bushing	100-018-1
11	4	Stem Seal Retainer Ring	100-019-1
12	1	Diaphragm Guide	100-022-2
13	1	Diaphragm Spring Plate	100-025-2
14	1	Shaft Spring Plate	100-026-1
15	1	POC Switch Actuator Shaft	100-033-1
16	1	Indicator Shaft Spring	100-030-1
17	1	Indicator Cap	100-031-1
18	1	Outer Valve Spring - 3-15 PSI (P.O.C. Model)	100-017-1
19	1	Outer Valve Spring - 6-30 PSI (P.O.C. Model)	100-017-2
20	1	Diaphragm Washer	100-024-2

Item	Qty.	Description	Part No.
21	1	Shaft Lock Nut	NHJF-0313-CS
22	3	Inner & Lower Cage Seal #020	O020-80H
23	1	Upper Cage Seal #024	O024-80H
24	1	Valve Seat Seal #114	O114-90H
25	1	Diaphragm Guide Outer Seat Seal #114	O114-80H
26	3	Stem Packing Seal #203	O203-80H
27	1	Body Seal #030	O030-80H
28	3	Packing Snap Ring	SRI-0625
29	2	Body Bolt	BHC-0313-2250-B7M
30	1	POC Position Switch	100-032-1
32	3	Lock Washer	WL-0313-CS
33	1	Plug Retainer Pin	PG-0094-0500-316
34	8	Spring Case Bolt	BHC-0250-1000-CS
35	2	POC Position Switch Retainer Screw	SR-2x56-0438-304
36	1	Specification Tag	100-042-2
37	4	Specification Tag Drive Screw	PD-0125-0125-CS
38	1	POC Switch Cover Plate	100-004-1
39	4	POC Switch Cover Bolt	BHC-0250-0750-CS
40	1	POC Switch Cover Gasket	100-044-1

Contact Us Toll Free: 1-855-226-2582

Phone: (403) 342-4494 | Email: sales@combustex.com | Web: www.combustex.com